

# Company presentation of the GET mbH

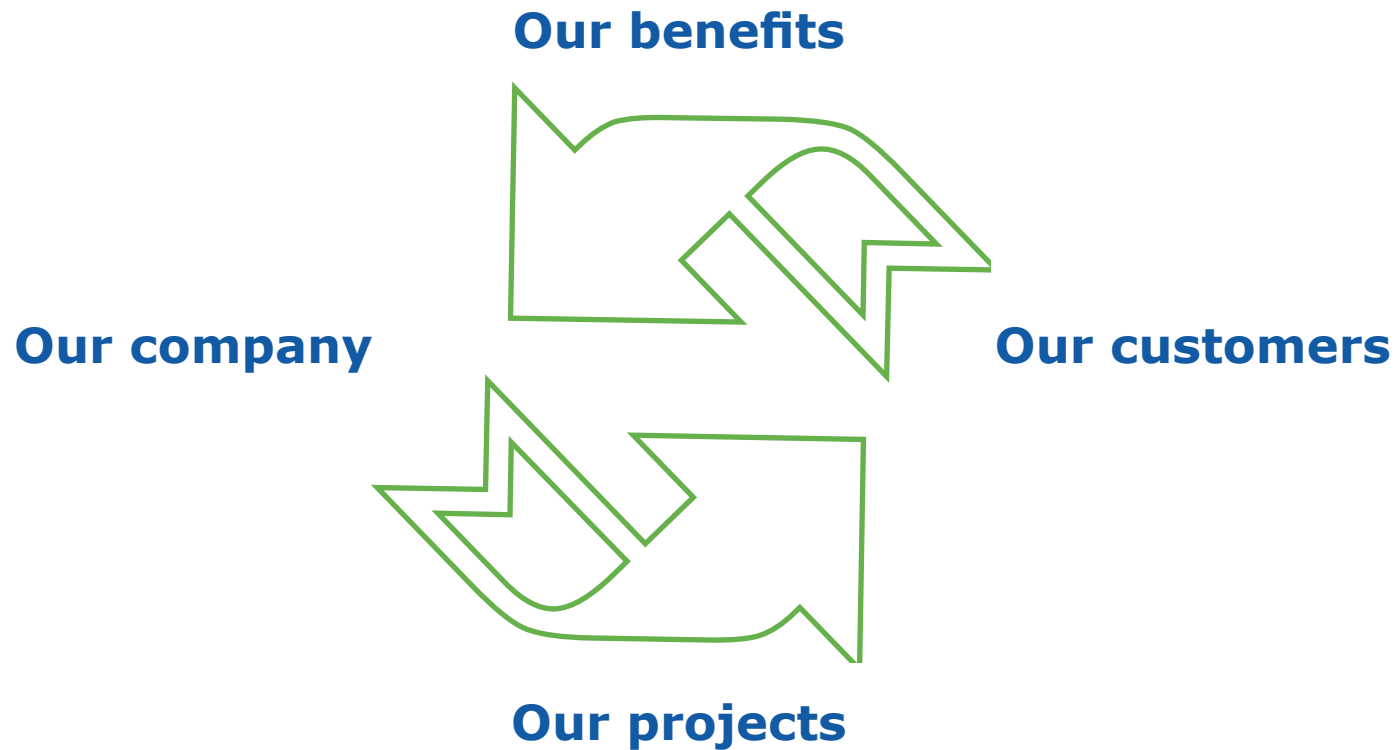

## About us

**The GET is an independent engineering company with the focus on**

- Energy and power station technology
- Plant engineering and piping construction
- Chemical process engineering
- Environmental technology

**Für unsere Kunden aus den Bereichen**

- Energy Industry
- Chemical and pharmaceutical industry
- Food industry
- Environmental technology

GET was established 1998 and has its domicile since 2000 in Schwetzingen.

Our employees are engineers and technicians in process and mechanical engineering.

The preparation of flow diagrams, layout plans and the isometric is made in 2D and 3D-CAD systems.

# Key aspects of activity

## Preliminary planning:

- built-in documentation
- system analysis
- energy and feasibility studies

## Basic engineering:

- determination from engineering basics
- design of chemical process construction and thermo technical construction
- concept of preparation from diagrams and installation planning
- calculation of investment costs and operational costs

## Governmental engineering:

- advices of amendment according § 15 BImSchG (Environmental legislation)
- building applications for LBO (Building regulations)
- permission applications for § 4 und § 16 BImSchG

## Detail engineering:

- preparation of chemical process and PID-diagrams
- description of construction and function
- planning for installation of machinery
- preparation of piping construction with isometric
- solicitation of quotations and preparation of specifications

## Some of our customers

- Adam Opel AG, Rüsselsheim
- ALSTOM Power Service GmbH, Mannheim
- BASF AG, Ludwigshafen
- BK Giulini Chemie GmbH & Co. KG, Ludwigshafen
- ERN Energiedienstleistungen Rhein-Neckar GmbH, Mannheim
- FRIATEC AG, Mannheim
- Fuchs Europe Schmierstoffe GmbH, Mannheim
- Goldschmidt TIB GmbH, Mannheim
- John Deere AG, Mannheim
- Maxtecc AG, Sinsheim
- MiRO Mineralölraffinerie Oberrhein GmbH & Co. KG, Karlsruhe
- NOVATEC BioSol AG, Karlsruhe
- Robert Bosch GmbH, Homburg / Saar
- ROCHE Diagnostics GmbH, Mannheim
- Rudolf Wild GmbH & Co. KG, Eppelheim
- Solvay Fluor und Derivate GmbH, Bad Wimpfen
- TWL Technische Werke Ludwigshafen AG, Ludwigshafen
- UHU GmbH & Co. KG, Bühl / Baden

# Project Information

**Customer: NOVATEC BioSol AG, Karlsruhe -  
completion 2009**

## Planning of a solar thermal power plant in Spain

### GET services:

- planning construction specification
- planning pipe construction
- calculation pipe construction
- testing by TÜV Süd
- as-built documentation

### Special requests:

- interpretation by EN13480-3 and EN12952
- wet steam design data's 330°C, 76bar, 5kg/s



Picture: solar thermal power plant PE1

# Project Information

**Customer: BMHK Malsch - completion 2009**

## Planning of a biomass heating plant

### GET services:

- chemical process and thermo technical calculation
- planning construction specification
- planning pipe construction
- statics and pipe construction calculation
- creation tender documents
- requesting und comparing offers
- governmental engineering
- participation in TÜV inspection
- assembling accompaniment

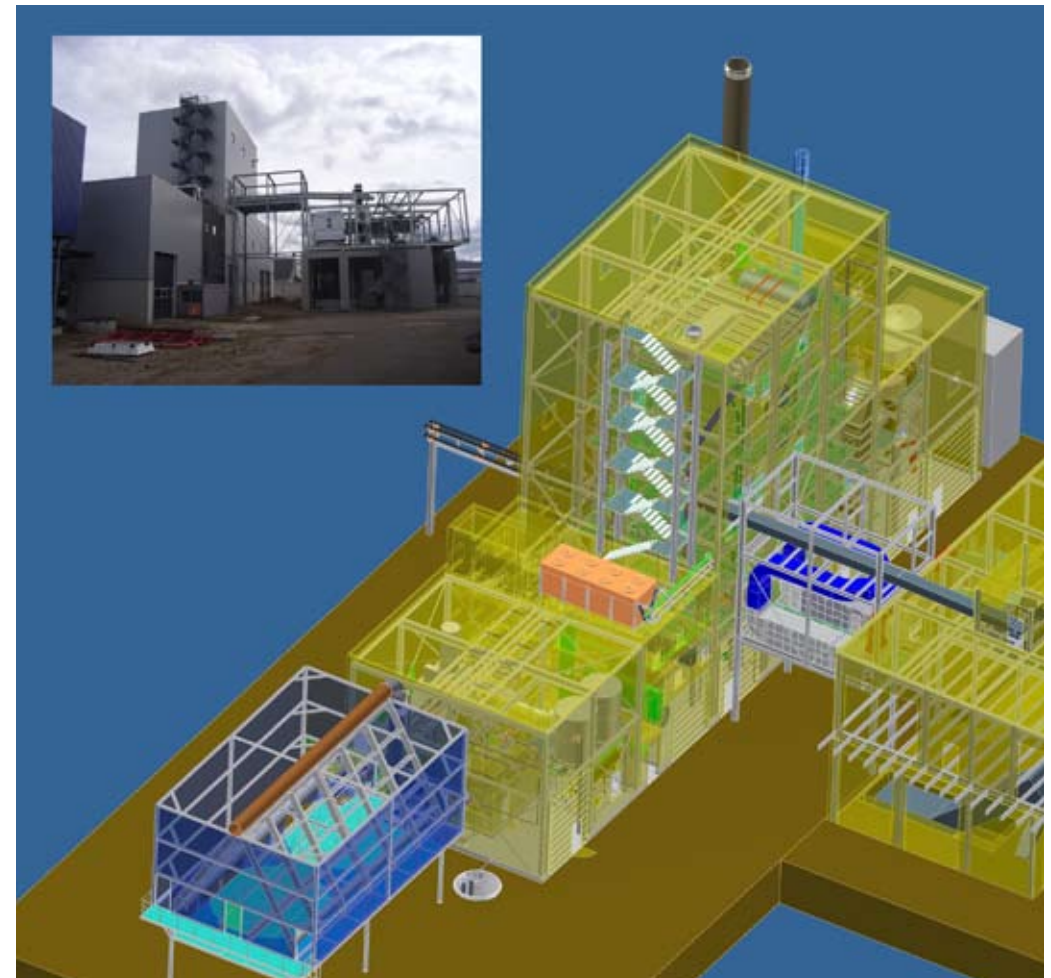

Picture: biomass heating plant in CAD 3D-modell

## Project Information

**Customer: Bertsch GmbH, Bludenz Austria -  
completion 2006 / 2007**

### Planning of the biomass heating plant KSV Crailsheim

#### GET services:

- Total planning with 3D-modell from the whole plant
- coordination from all trades
- planning air ducts
- planning hot steam system
- planning feed water system
- calculation pipe construction

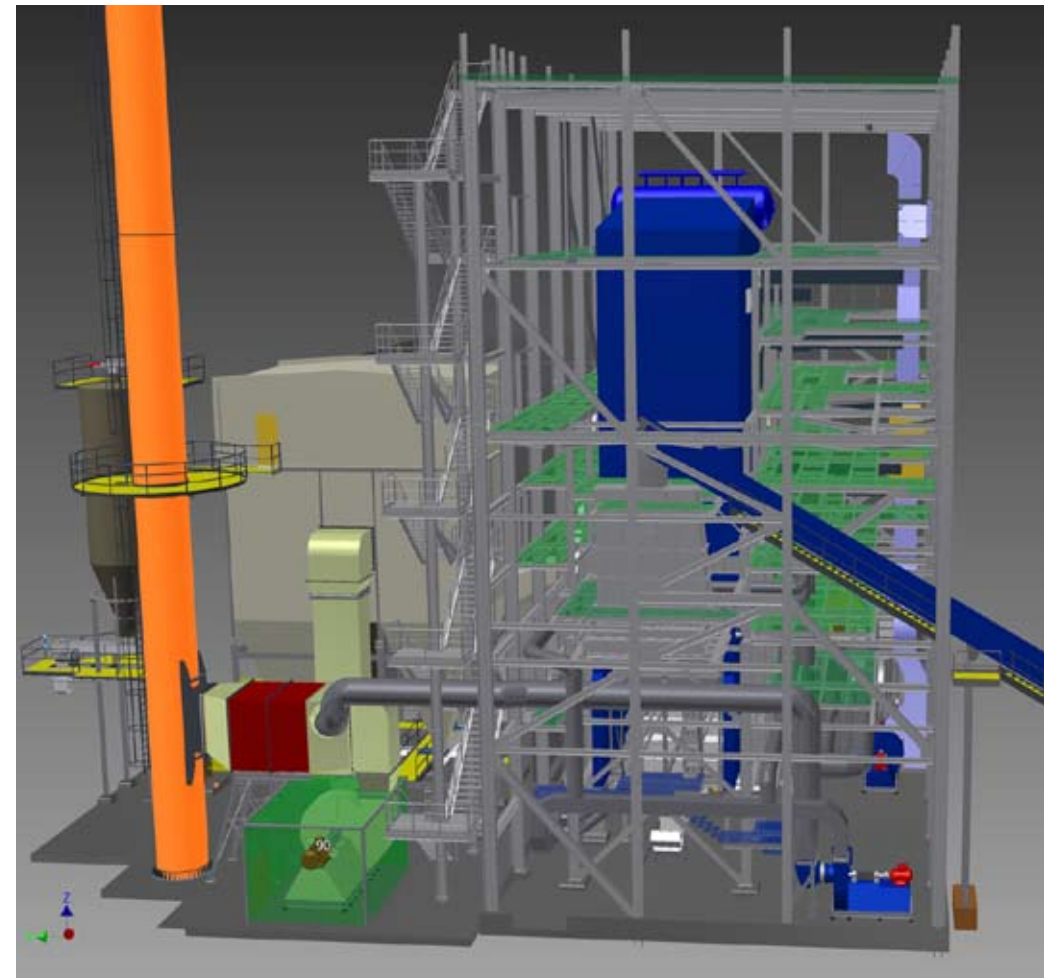

Picture: biomass heating plant with dust collector in CAD 3D-modell

# Project Information

**Customer: Maxxtec AG, Sinsheim - completion 2006**

**Planning of a hot oil unit for  
process heat supply in Texas**

**GET services:**

- draft planning
- completion planning
- assembling accompaniment

**Special requests:**

- planning with ANSI/ASME-standards
- temperature up to 350°C
- consideration extreme wind loads (hurricane-zone)



Picture: Hot oil unit in CAD 3D-modell



## Project Information

**Customer: Goldschmidt TIB GmbH, Mannheim -  
completion 2005**

**Planning of a production line  
for manufacturing tin sulfate**

**GET services:**

- governmental-engineering for permission application § 4 BImSchG incl. building application
- preliminary planning
- completion planning

**Special requests:**

- complete planning incl. requirements for building services engineering
- 3D-modell design for the building, steel structure, production line and pipe construction

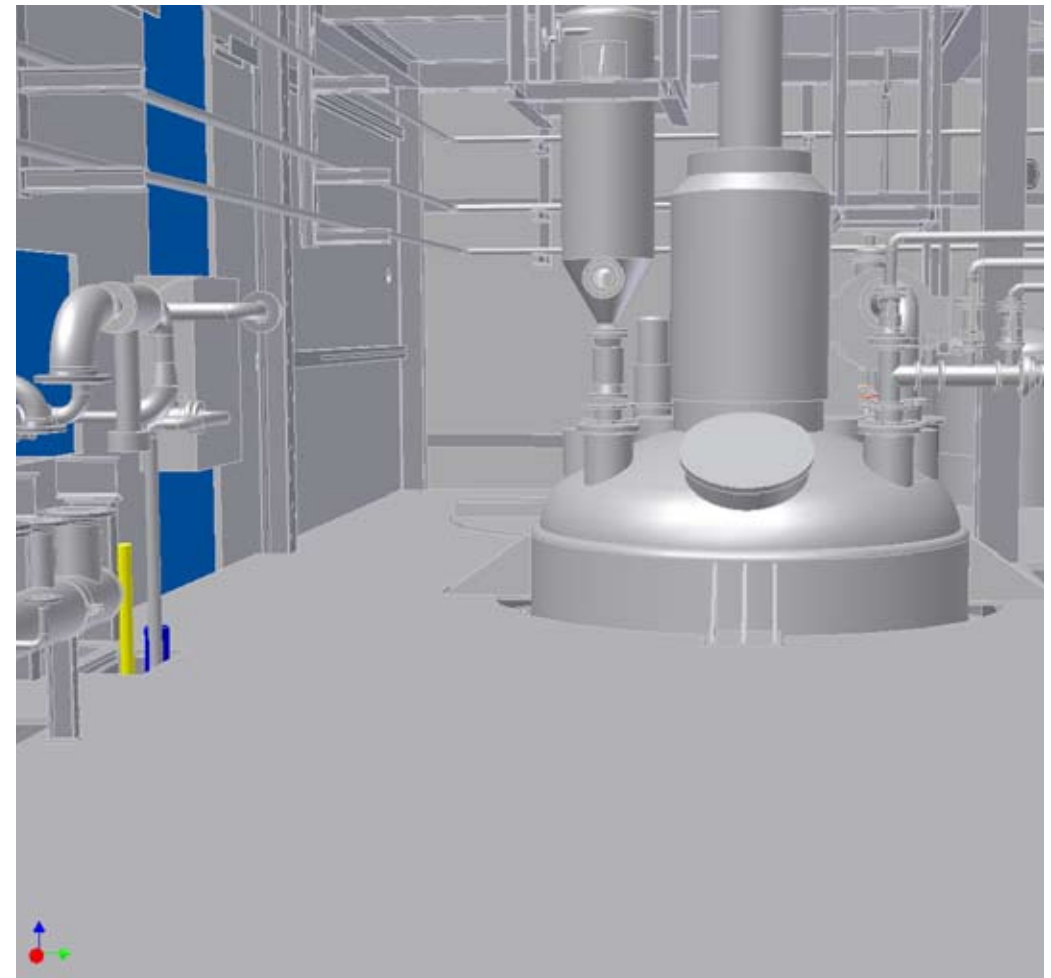

Picture: reaction container with connections in CAD 3D-modell

## Project Information

**Customer: Fuchs Europe Schmierstoffe GmbH, Mannheim - completion 2005**

**Planning of a unit for recipe-controlled manufacture of motor oils from several basic oils and additives**

### GET services:

- draft planning
- completion planning
- assembling accompaniment

### Special requests:

- absolute symmetrical routing of all pipes with the exact lengths to guaranty the correct final proportions

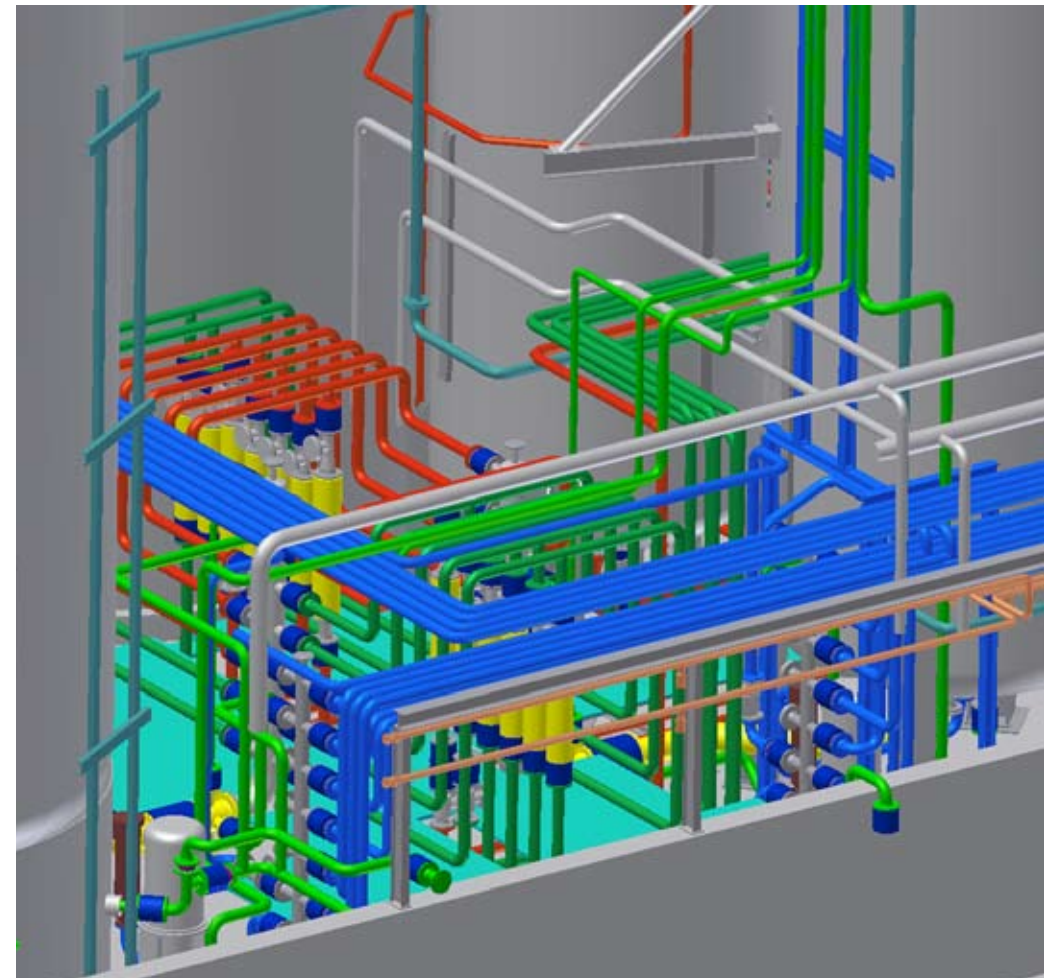

Picture: Piping from a meter station in CAD 3D-modell

# Project Information

**Customer: FRIATEC AG, Mannheim - completion 2006**

**Lead-through of a risk assessment after the new direction on hazardous materials (GefStoffV)**

## **GET services:**

- Ermittlung und Prüfung der Grundlagen für die Gefährdungsbeurteilung
- Prüfung und Aktualisierung des Gefahrstoffkatasters
- Erstellung einer „Handlungsanleitung für Gefahrstoffe ohne Arbeitsplatzgrenzwert“
- Durchführung der Gefährdungsbeurteilung für die Betriebsbereiche mit Dokumentation
  - Arbeitsplatz- und gefahrstoffbezogene Ermittlung der Schutzstufen und Festlegung der Schutzmaßnahmen
  - Überprüfung der Mindeststandards für Tätigkeit mit Gefahrstoffen nach TRGS 500

# Project Information

**Customer: ERN Energiedienstleistungen Rhein-Neckar GmbH, Mannheim - completion 2005**

**Supply of Weylchem GmbH with 16 bar steam from ERN on the premises of ROCHE Diagnostics GmbH**

## **GET services:**

- governmental-engineering (coordination with regional council, building application)
- planning pipe bridge with steel structure drawings, foundation drawings
- statics and pipe construction calculation
- planning steam pipes with pipe construction calculation
- creation tender documents
- requesting und comparing offers
- assembling accompaniment
- support for commissioning